

PCIe (NVMe) M.2 SSD Duplicator 1 to 11 (PV1200)



Valutazione: Nessuna valutazione
[Fai una domanda su questo prodotto](#)

Descrizione

PCIe M.2 Duplicator 1-11 (PV1200)

- Speed transfers up to 12.0 GB per minute.
- Supports hot swapping.
- Auto-detect NVMe and SATA M.2 SSD.
- Support cross-signal duplication.
- Systems & files copy mode supports Windows (FAT16/32/exFAT, NTFS), Linux (ext2/ext3/ext4) and Mac (HFS, HFS+, HFSX).

- Data Sanitization: Quick Erase, Full Erase, DoD Erase and Secure Erase.
- Supports M key and B+M key for M.2 PCIe devices.

- [Product Description](#)
- [Features](#)
- [Specification](#)
- [Comparison Chart](#)
- [Video](#)

Product Description

The new generation PV1200 PCIe duplicator is a professional NVMe M.2 duplicator. It is designed specifically for small volume users and adopts high level FPGA closed platform design, which can eliminate the possibilities of virus infection completely.

We guarantee the highest productivity without speed degradation even as the number of targets increases. It provides four copy modes: quick smart copy, all partitions copy, percentage copy and whole copy that all meet different duplication task requirements. The quick copy mode copies data and skips blank area. NTFS, Linux (Ext2/Ext3/Ext4), FAT/FAT32/exFAT and Mac (HFS, HFS+, HFSX) formats can all be supported with quick copy mode.

In addition, the PV1200 M.2 duplicator is equipped with different levels of erase functions, Quick Erase, Full Erase, DoD Erase and Secure Erase government standards, which can fulfill different levels of PCIe wiping security.

Features

- **Impeccable Efficiency**

U-Reach PCIe M.2 duplicator copies at **12.0 GB/m** on all PCIe M.2 simultaneously, without any speed degradation as number of targets

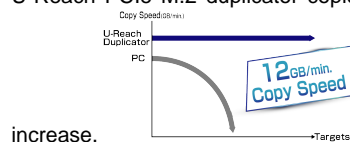

- **No Waiting Time Required for Duplication**

When each round of duplication is completed, the next round can start immediately without having to wait or restart the machine.

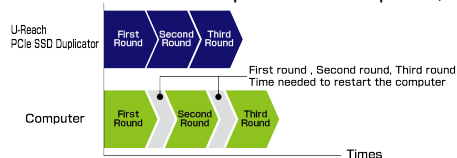

- **Intelligent Duplication Modes**

U-Reach PCIe SSD duplicator offers a diverse of duplication modes. The user may select the appropriate mode based on application demand.

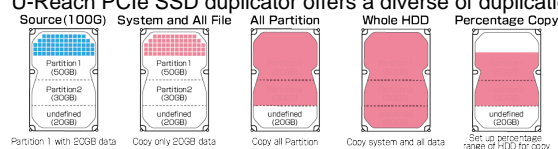

Illustration of Copy Modes:

The areas containing data are marked in blue. The areas being copied are marked in red. Duplication time depends on the speed supported by the hard drive's controller chip.

• Sanitization methods

?Quick Erase:
Erase HDD index table, and only takes A FEW SECONDS to complete.

?Full Erase:
Erases the entire HDD.

?DoD Erase:
Complies with U.S. Department of Defense erasure standards.

?Secure Erase:
A National Institute of Standards and Technology 800-88 accepted technique for properly purging hard drives. This method is supported by almost all modern SATA/SAS HDD.

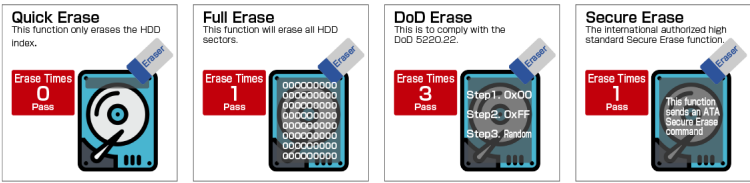

• High Compatibility

?Quick copy mode supports Windows (FAT16/32/64), Linux (ext2/ext3/ext4), and Mac (HFS/HFS+/HFSX) formats.
?Whole media copy mode supports all system and proprietary formats.
?Supports various brands.
?Designed to support 18TB+ capacities.
?Supports MBR and GPT partitioning.



Specification

			Model Target	PV1200 11
Specific ation	Maximum Transfer Speed	12.0GB/min. (200MB/sec.) *Actual performance is dependent on SSD transfer speeds*		
	Capacity	Supports the latest market available capacity Designed support capability up-to 18TB+		
	Operating Type	Stand-alone, FPGA-based operation (Non PC-based)		
	Supported Languages	English, Japanese		
	LCD Display LEDs	Backlit Monochrome LCD Display 3 LED Indicators per Port: Yellow (Power), Green (Pass), and Red		

Features	Control Panel	(Fail) 4 Push Buttons(?, ?, OK, ESC)
	Copy Modes	Quick Copy (Systems & Files Copy), All Partition Copy, Whole Device Copy, Percentage Copy
	Compare Function	Bit-by-bit data comparison
	Sanitization Modes	Quick Erase, Full Erase (NIST 800-88), and Secure Erase
	Compatible Devices	NGFF (M.2): 2230, 2242, 2260, 2280, PCI-e SSD (full and low profiles)
Compatibilities	Supported Formats	Quick Copy: FAT16/32/exFAT, Windows (NTFS), Linux (Ext2/Ext3/Ext4), and Mac (HFS, HFS+,HFSX)
	Supported O/S	Whole Device Copy: All Formats, including proprietary formats All (Windows, Mac, Linux, and other stand-alone systems)
	Power Supply	Universal Power: 115VAC or 230VAC, 50/60Hz
	Working Temperature	5°C ~ 45°C (41°F ~ 113°F)
	Storage Temperature	-20°C ~85°C (-4°F ~ 185°F)
Hardware specification	Working Temperature	20% ~ 80%
	Humidity	
	Storage Humidity	5% ~ 95%
	Product	50 x 26 x 14.7
	Dimensions (cm)	
	Weight (kg)	8.87
	Certifications	FCC, CE, RoHS

Comparison Chart



M.2 SSD Duplicator / Eraser Comparison Chart

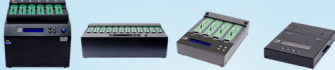

Series / Model	PE	PE-H	PV	PX		SP	
				PX400	PX800	SP101	SP151
Ports	1-5; 1-10; 1-15; 1-20		1-11; 1-23	1-3	1-7	1-1	
Speed (GB/min)	24.0	60.0	12.0	9.0	12.0	9.0	24.0
Supported Protocol	NVMe, SATA (Auto Detect)						
Supported Interface	Direct	M.2	M.2	M.2		M.2 & SATA	
	Through Adapter	U.2, SATA, PCIe, MAC PCIe SSD, BGA SSD	PCIe, MAC PCIe SSD	PCIe, MAC PCIe SSD		MAC PCIe SSD, PCIe, mSATA, CFast	
Cross-Signal Copy	V		V	V		V	
Copy	V		V	V		V	
Full Erase	V		V	V		V	
Secure Erase	V		V	V		V	
DoD Erase	V		V	V		V	
Event Log Report	V						
SMART Info	V			Power Cycle, Power-on Hours, Temperature		V	
Image Management	V						

The Data Equipment Expert Duplication / Inspection / Sanitization

www.ureach.eu

Video

